

# SU-EM-8WD-G2

EMERGENCY DRIVER FOR LED HOOK-UP

## FEATURES

- UL listed for field or factory installation,CEC title 20 compliant
- Compliance with American NFPA 101 life Safety Code
- Constant output power
- 2 -in- 1 LED test switch and indicator light included
- Manual testing via remote control (optional)
- Monthly/annual self-testing
- With multi-protection function:
  - Battery overcharge protection
  - Battery over-discharge protection
  - Output overload protection
  - Short-circuit protection
  - Open load protection
- 5 years limited warranty.

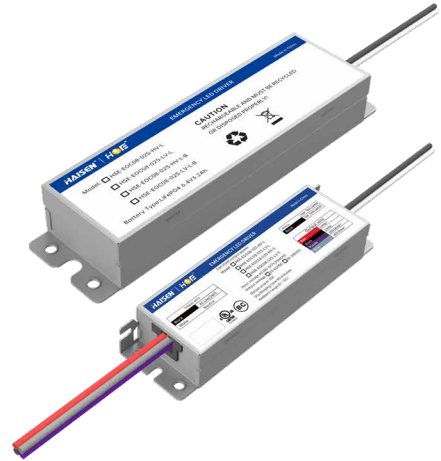

## ELECTRICAL SPECIFICATIONS

- Input voltage: 100-347VAC,50/60Hz
- Input current: 0.05A max
- Input power: 5W Max
- Power factor: 0.5 @220VAC
- Recharge duration: 24Hrs
- Emergency duration: 90min
- Max. casing temperature tc: 75°C (167°F)
- Ambient temp: 0°C ~ +55°C (-32°F ~ +131°F)



Self Test

## MODEL SELECTION TABLE

Models	Output voltage	Emergency Wattage	Battery pack	Max. load current	Battery dimension
SU-EM-8WD-G2	20-300V DC	8W	6.4V 3200mAh	1A	165*43.5*25.4mm

## NORMAL MODE

Fixtures will operate normally when power is available. When an outage occurs, the fixture will switch to emergency mode, delivering power to the fixture for up to 90 minutes.

## EMERGENCY MODE

1. The emergency battery backup enters the emergency mode immediately after the mains power failure.
2. Stop the emergency and return to the charging state after the mains power call.

## SELF-DIAGNOSTIC

### MONTHLY SELF-TEST

It will automatically perform a monthly self-test every 30 days with a duration of 30S to check whether the emergency function is normal, and automatically restore to normal charging after 30S discharged.

## ANNUAL SELF-TEST

An annual self-test will be done every year (12 months) with a duration of 90mins to check whether the capacity of the battery pack is normal, and automatically restore to normal charging after fully discharged. (the condition of annual test is that the battery pack is fully charged).

If the annual inspection is interrupted, it will be retested after recovery and when the test conditions are met. (Possibility of interruption: such as sudden power failure, sudden manual test).

## TEST BUTTON & LED INDICATOR

Operations	Test button operations	Red indicator status	Working status
Normal mode	Press the test button	OFF	Emergency mode
	/	OFF	Monthly testing
	/	OFF	Annual testing
	/	ON	Battery is charging or fully charged
Emergency mode	Press the test button 5S	OFF	Turn off the battery pack
Malfunction mode	/	Flashing	1.The battery pack is disconnected or it is broken. 2.The load is disconnected. 3.Short circuit or open circuit. 4.The wires are not connected properly.

## ACCESSORIES



Regular plastic test button (Default)

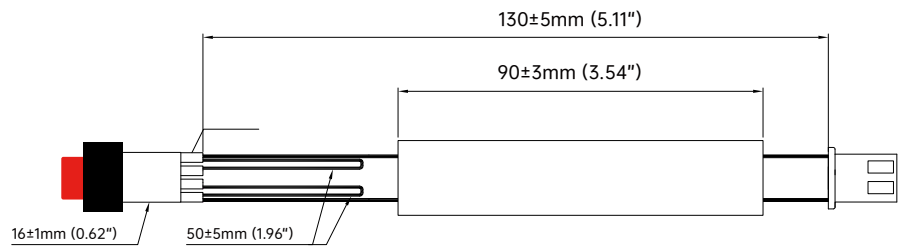

Waterproof test button

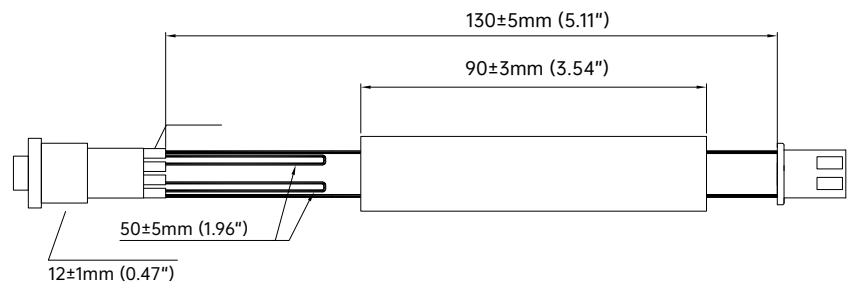

**DIMENSION**

**Battery Pack**

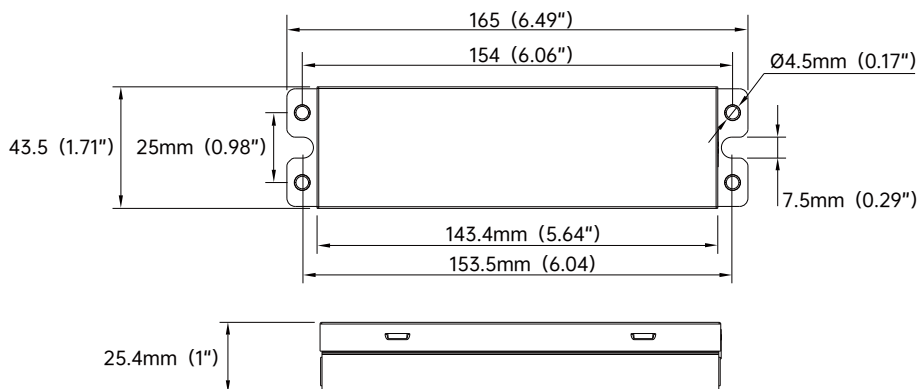

**Emergency Driver**

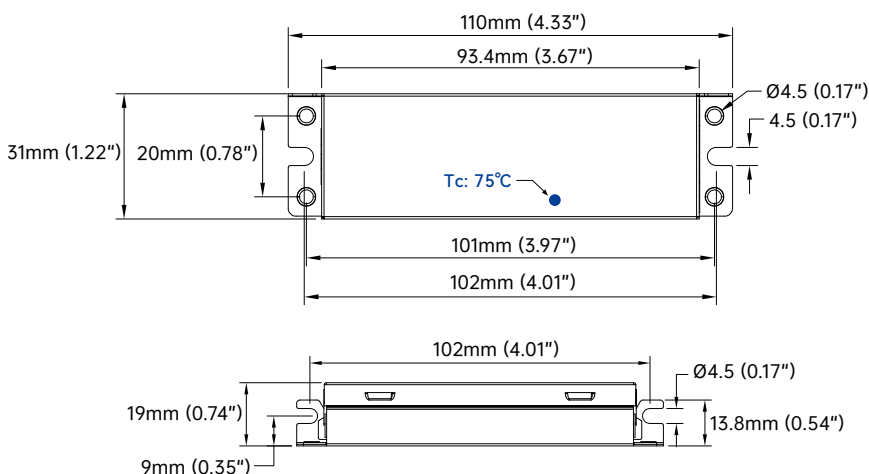

**WIRING DIAGRAM**

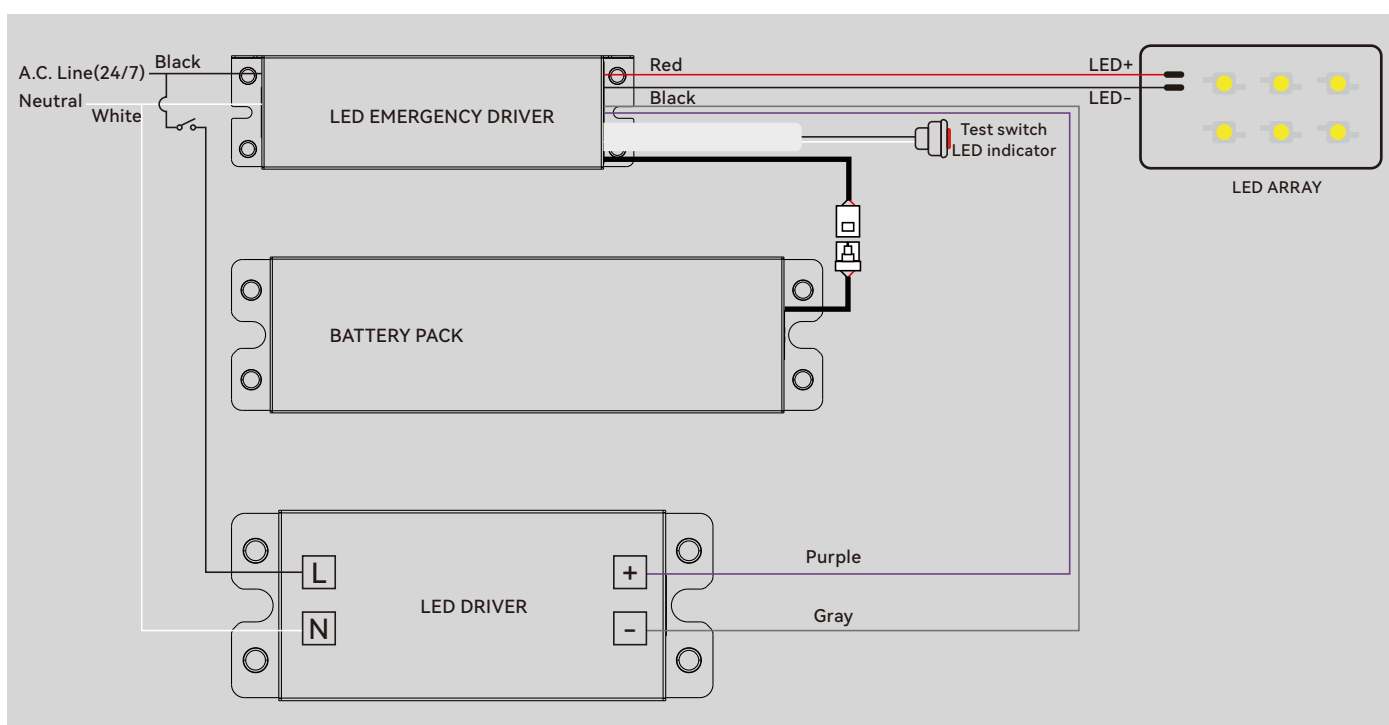

## IMPORTANT SAFEGUARDS

When using electrical equipment, basic safety precautions should always be followed, including the following:



### CAUTION

### READ AND FOLLOW ALL SAFETY INSTRUCTIONS



1. CAUTION – To prevent electrical shock, do not mate unit connector until installation is complete and AC power is supplied to the unit.
2. CAUTION – This fixture provides more than one power supply output source. To reduce the risk of electrical shock, disconnect both normal and emergency sources by turning off the AC branch circuit and by disconnecting the unit connector.
3. CAUTION – This is a sealed unit. Components are not replaceable. Replace the entire unit when necessary.
4. CAUTION – Installation and servicing should be performed by qualified personnel only. De-energize before opening.
5. The series is for Use with grounded, Listed, dry or damp location rated fixtures and the enclosure is grounded. Not for use in heated air outlets or hazardous locations. Not for use in heated air outlets or hazardous locations.
6. The series requires an unswitched AC power source of 100 to 347 volts, 50/60 Hz.
7. The series and AC driver must be on the same branch circuit.
8. Do not mount near gas or electric heaters.
9. The series should be mounted in locations and at heights where it will not readily be subjected to tampering by unauthorized personnel.
10. The series will supply 20-54V DC / 20-60V DC or 20-300V / 90-300V DC output at the individual rated specification for 90 minutes.
11. Suitable for use in damp locations and plenum spaces.
12. Flexible metal conduit is optional, depends on installation environment.
13. For use in 0° C minimum, 55° C maximum ambient temperatures.
14. Do not use this equipment for other than intended use.
15. Install in accordance with the National Electrical Code and local regulations.
16. Lighting fixture manufacturers, electricians, and end-users need to ensure product system compatibility before final installation.